

A
D P 338086

No 7 FISHER AVENUE
B
D P 338086

10
D P 1256987

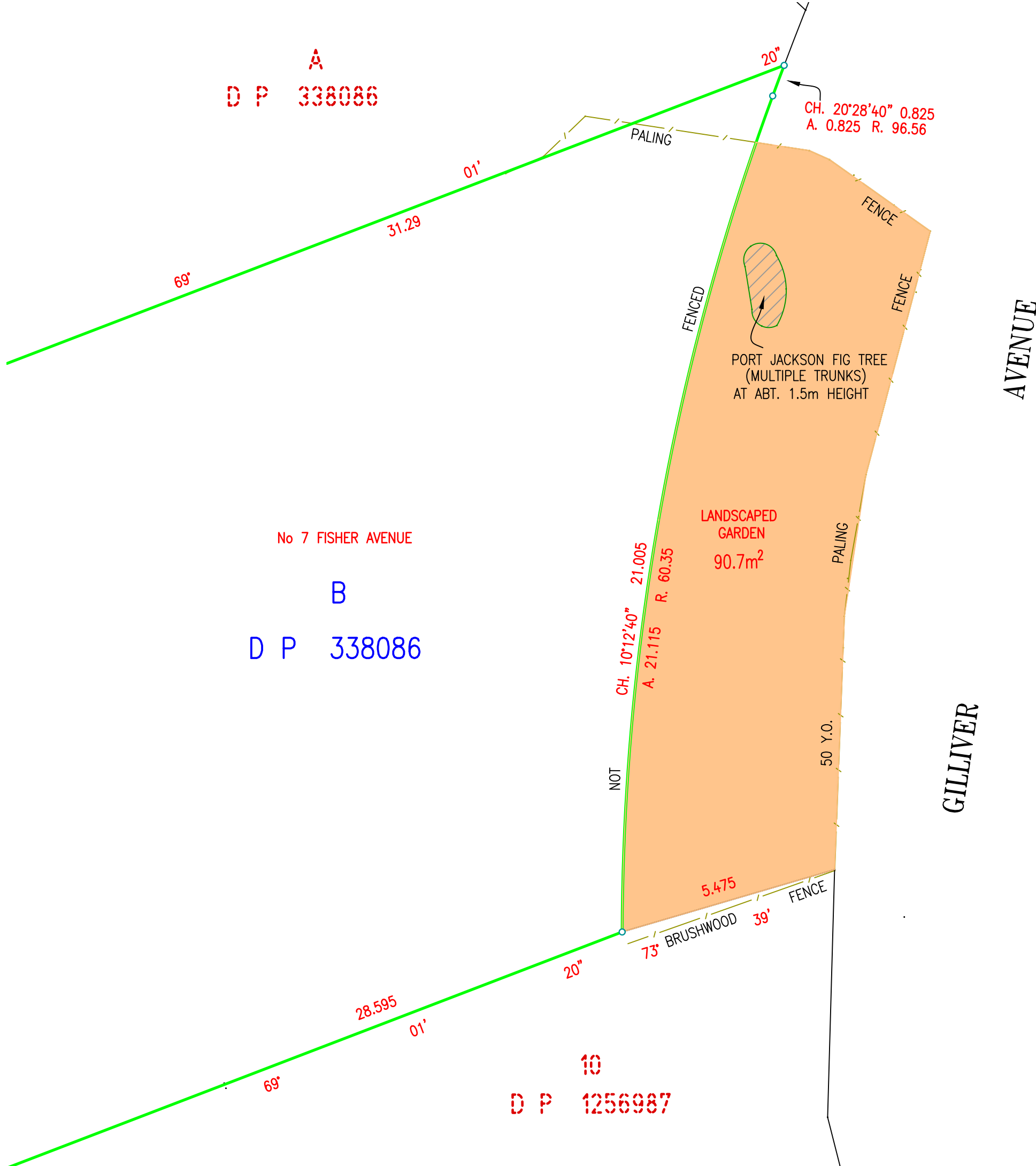

M.G.A. NORTH

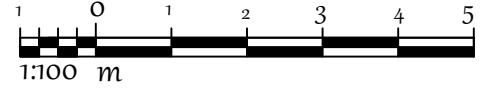

HORIZONTAL SYSTEM: MGA 2020
 MARK ADOPTED:
 E 333 000.000
 N 6 000 000.000

VERTICAL SYSTEM: A.H.D. 71
 BM ADOPTED SSM XXXXX
 R.L.XXX.XX CLASS XX ORDER XX

CLIENT:
 WOOLLAHRA COUNCIL

PROJECT:
 PLAN SHOWING AREA OF GILLIVER AVENUE
 PROPOSED FOR SALE TO
 No 7 FISHER AVENUE, VAUCLUSE



SCALE:		A1	
HOR	VER		
LGA: WOOLLAHRA		SHEET 01 OF 01 SHEETS	
DRAWN	P.H.	SURVEYED	I.S.
REFERENCE		REVISION	
22072-ID		A	